



# Deck Max<sup>TM</sup>

## Deck-Max Bamboo Installation Data Sheet



### Installation tips and Recommended instructions.

- SPECIFICATION: 1850mm x 137mm x 20mm
  - o Pre-grooved both sides
  - o End matched – not required to cut and join on joists



- o Janka Hardness – 3,820 lbf Janka Rating – Twice that of Merbau 118mpa
- o Bal 29 – Fire rating
- Joist Centres 350mm max 450mm (the closer the joists are the more rigid the deck boards will be)
  - o If laying on the diagonal, then Joists should be closed up to 300mm.
  - o Recommended 45mm wide joists
  - o Frame should be built with noggins at no more than 800mm apart
  - o Be sure all end grains of frame cuts are sealed with an exterior primer paint
  - o It is recommended that the top of all framing be treated with the same exterior primer paint.
  - o We DO NOT recommend the rubber flashing or other rubber materials on top of joists - You are welcome to email us to discuss this issue.

**Refer to the Woca Coating data sheet - you can coat like normal hardwood. It takes the best of Composite (Wood Plastic) & (Hardwood) to deliver the most stable material in the world. Perfect for Decks close to ground**



**Note:** You can layup the Ultra set on the bottom lip of the receiving end of the end matching - see red arrow on the image above.



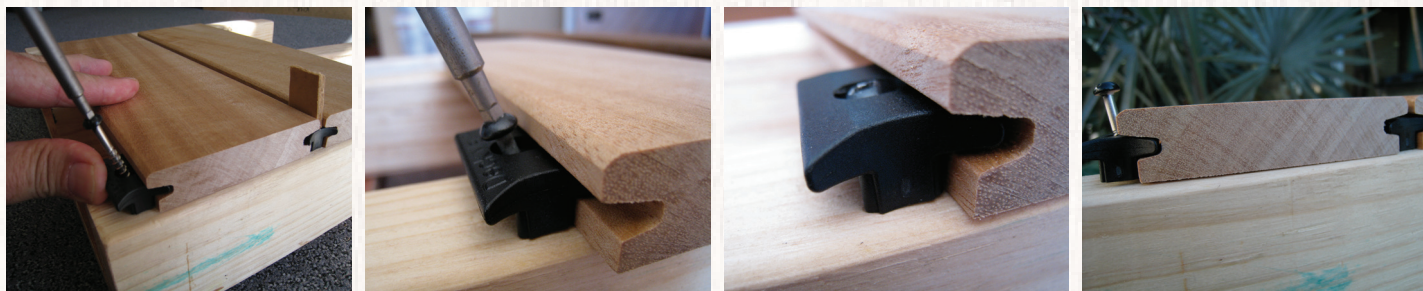

- Clips and screws:
  - The boards are pre-grooved to receive the Deck-Max hidden fastener.
  - Clip and screw are made of 304 Stainless Steel – powder coated.
  - ONLY use the Deck-Max clips and screws provided – any alternative fixing used will void any warranty claims.
  - Clips should be pushed firmly into the groove on the side of the board and retained in that position while fixing the screw.
  - Insert the screw - See steps above for correct fixing, see on live videos under Pro Clip.
  - We will supply Bostik UltraSet to lay up on top of the joist to provide an acoustic membrane to remove the rattle and squeak.
    - Depending on the sub frame you may require pre drilling prior to fixing the screw
    - Do not over drive the screw when fixing. If you have a problem engaging the next board then you may have over tightened the screw into the clip and or have not kept the clip tight into the groove therefore creating a wider gap setting than the others.
    - Be sure to only use the correct driver bit to match the screws
    - Do not fix screws with fast speed or you run the risk of breaking the screw and or burring the rebate on top of the screw.
    - Be sure to insert the driver bit firmly into the head of the screw prior to fixing so you do not bur the head. Use the Deck-Max 100mm #2 sq. driver bit. See photo steps above for simple installation of the clip & screw.
  
- Cutting tools:
  - It is recommended that a fine-tooth blade be used for a finer cut
  - Blades with more teeth is recommended say a 60 tooth on a 180>200mm blade.
  - When cutting any ends, it is best practice to seal all cut ends – failure to do so will void any warranty.
  
- Clamping of boards:
  - During installation it is recommended that Decking clamps be used to maintain the gap setting.
  - If tapping board into position ONLY use a rubber mallet or tap to another piece of timber BUT do not hit the side of the board directly with a hard hammer.

### dasso.XTR Features



Environment-friendly



Termite-resistant



Fire-proof



High stability



High Density



High hardness



15-year durable



Corrosion-resistant



Mould-resistant



Good dimension stability



RESIDENTIAL AND COMMERCIAL APPLICATIONS





Image # 1

Apply Polyurethane in a thick bead the width of each board.

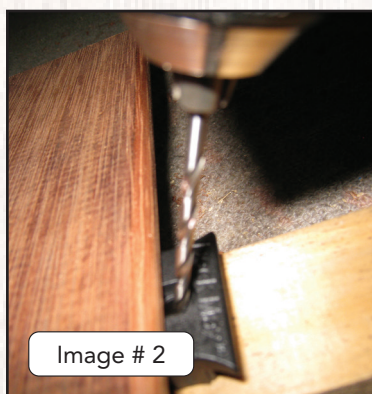

Image # 2

If required run a pilot hole for the perfect fit with a 3mm drill bit for pine joists and maybe a 4mm drill bit for hardwood.



Image # 3

Use clamps to pull boards in tight and also retain board down to the frame prior to fixing the clips.



Image # 4

Be sure to hold the clip firmly into the groove while fixing the screw. Insert Screw at the 5 to 10-degree angle to avoid bushing the top side of the board. Fasten the screw head into the rebate but do not over tighten.

## Best Practice Tips

1. Refer to the data sheet for "Decks Close To Ground" by Deck-Max.
2. Apply dark coloured Timber Primer paint to the top of the joists as a layer of protection from rot.
3. Insert noggins to stiffen up frames that are often not inserted in both steel & timber frames. This prevents the framing twisting and creating an unstable sub frame. See image below.

*\* If in doubt on any aspects of this system call Deck-Max for advise.*



Note: When fixing Deck-Max™ - always follow the joists as your point of fixing as in many cases the joists may run off at angles. Simply insert a Deck-Max™ when ever the board intersects with a joist. Deck-Max™ is a proprietary system and must be installed as per manufacturer's specifications. Deck-Max™ does not warrant the board or sub structure. Always use the necessary safety equipment and protective ware.



## Butt Joints - Mitred Corners - Framing Boards see diagram # 2, #3 & # 4 below.

Joiner Biscuit see diagram # 1 - Using a biscuit cutter insert the cut / kerf into the face of the join as in Diagram # 2. Be sure cut is same on both timbers that you are joining – test run your settings and measurements before starting. Insert biscuit cut to both faces / end same as side lateral cut [set/hold board with clamp so it does not spin off with the direction of the biscuit cutter] Use one per 90 mm butt joint, Use two per mitre – Use two on each joint of wider boards like the 140 mm. You will fit the Deck-Max™ in its normal manner on the side plus the butt joiner as in diagram # 2. Insert glue [same as used on joists] then fit biscuit tap butt joint tight and fix – clean off all excess glue that appears on the deck surface. Mitred corners and framing boards – use the Deck-Max™ joiner.



Diagram # 1

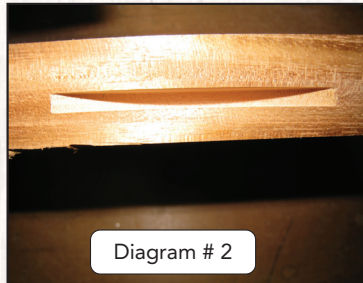

Diagram # 2



Diagram # 3



Diagram # 4

## Wood Plugs and Counter Bore Tool



1



2



1 Counterbore Tool

2 Counterbore Tool Assembly

3 Counterbore Tool Allen Key Adjustability

4 Wood Plug and Screw for Timber or Metal Frame



3



4



Click the link to see **Wood Plug Kit - Hardwood**



# Decking Clamps



These Deck Clamps are essential for keeping the gap setting as you install the boards. See videos on the website.

- Spacing off buildings / walls:
  - o Follow local codes and pest inspection guidelines to set back off walls when building close to a wall
  - o Some codes require pest inspections – use local guides for this guide.
- Storage prior to installation: Bamboo should be kept from direct sunlight, and inclement weather before installation.
- Follow best practice for Decks Close to ground – refer to Deck-Max technical data Sheets for specifications.
  - o If decks are built close ground and the guidelines of the Technical data sheets referred to are not followed the warranty is Void.
- All deck constructions must be built to the building code of your area.
- It is the sole responsibility of the purchaser that all codes are adhered to.

## Finishing:

- When you approach the last few boards you will need to possibly rip a board lengthways to trim to wall.

## Start and Finish Tools:

- CounterBore tool and or the Counter Sink tool can be used in conjunction with each other.
- The CounterBore tool matched with the screw and Specific Plug are the recommended fixing options and please review the product on the website for clear instructions.
- The CounterBore tools are matched with the wood plug and screws in our recommended inclusions. Use for face fixing Fascia as well.



**Note:** After preparing the board with either tools - You MUST run a 3.5 or 4mm Long shank drill bit into the same hole to ensure the screw does not break as the bamboo is so hard. We recommend a trial before doing the on main area.



RESIDENTIAL AND COMMERCIAL APPLICATIONS



# Fascia - grooved one side only Boards

- When designing the fascia / Riser board here are 3 x options.
- Dasso does provide a board groove one side only.
- In Option A this single sided grooved board would be used on the last board on the top.
- In Option B this single sided grooved board would be used on the Front and set flush to the top of the decking boards.
- Or in Option C – Mitre the corners.

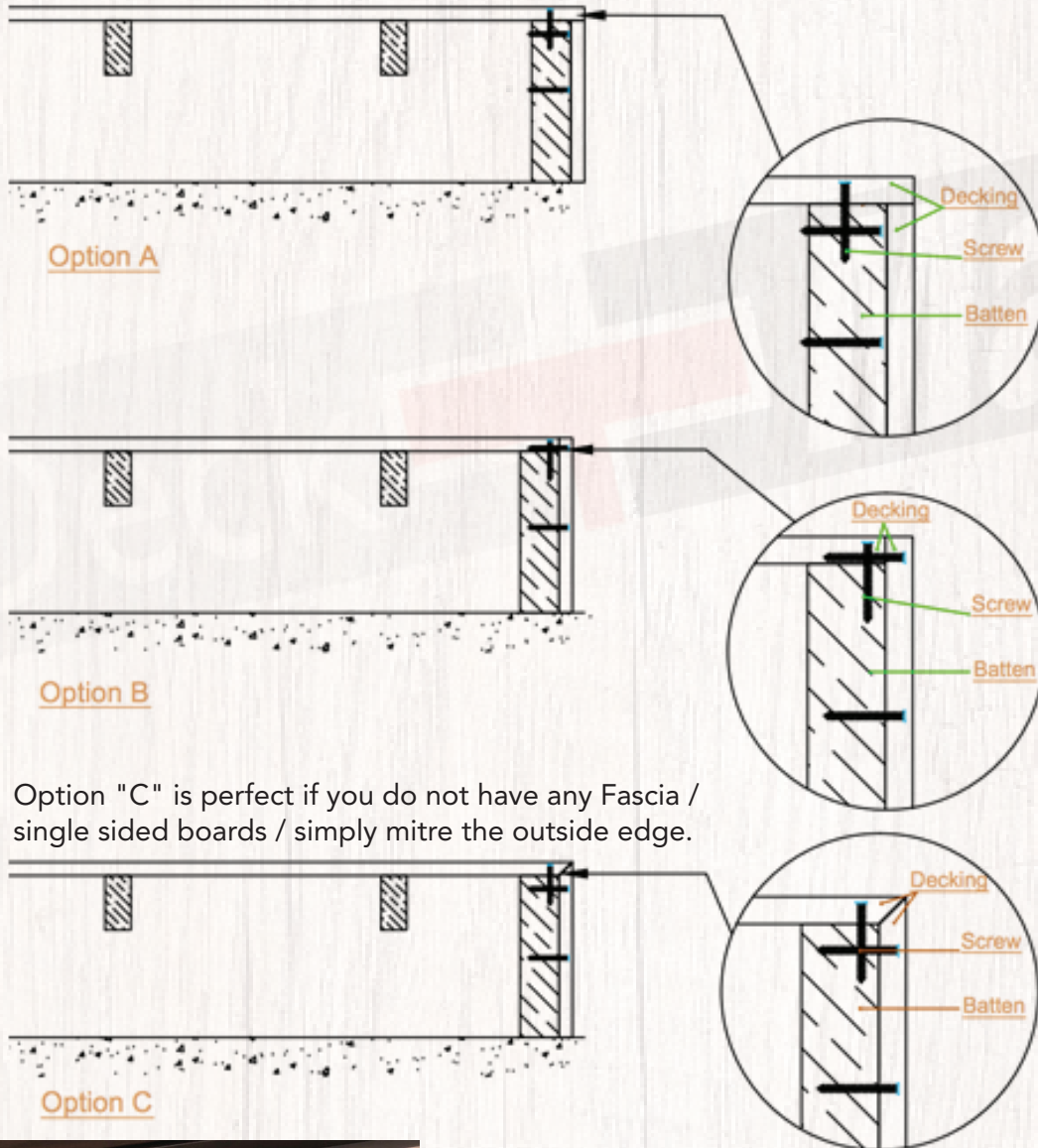

Finish as per Diagram "A" using wood Plugs



RESIDENTIAL AND COMMERCIAL APPLICATIONS



# See below for layout ideas when laying short boards

Layout # 1 - Picture Framed Staggered pattern / centre to centre

Four sides 3 boards are needed. Spacing in the middle and ends

<b>Product</b>	XTR-OR20-02-PP decking plank: 20mm x 137mm
<b>Sub</b>	Framing 12", 16", 24" Center to Center
<b>Manufacturer</b>	Line 1, Date: Jan 01, 2018 Issue: 1.1 Contact: 1-804-891-6872
<b>File</b>	XTR-OR20-02-PP-OR20

Layout # 2 - Staggered Pattern / centre to centre

<b>Product</b>	XTR-OR20-02-PP decking plank: 20mm x 137mm
<b>Sub</b>	Staggered 12", 16", 24" Center to Center
<b>Manufacturer</b>	Line 1, Date: Jan 01, 2018 Issue: 1.1 Contact: 1-804-891-6872
<b>File</b>	XTR-OR20-02-PP-OR20



RESIDENTIAL AND COMMERCIAL APPLICATIONS



Layout # 3 - Staggered based on Joist centres

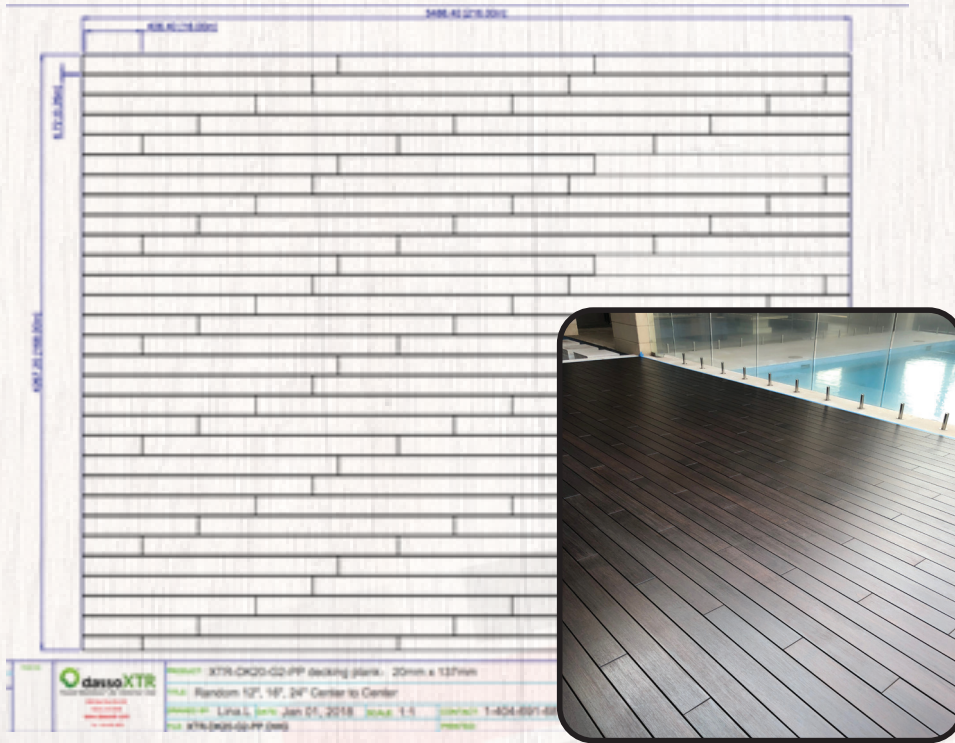

Care and Coatings

The Dasso material is supplied in what we call a raw board providing you with 2 x options.

**Option # 1** - After installation it is recommended that 2 x coats of the Woca oil be applied - See Woca Data Sheet. If after the initial coatings you may choose to let it fade noting that bamboo is similar to hardwood that is not coated - The texture can vary and silvering will occur. To clean simple wash with a light detergent and soft broom - rinse off with water and a wide Squeegee is best to remove the surface water or you can get small water marks on the surface.



**Note:** Protect decking during installation - lay down rubber matting and keep all other trades off the deking.

**Option # 2** - Refer to manufacturer for coating information.



**Note:** Follow all manufacturers direction and advises as offered by them. The timing between coatings will depend on the location and climate you are in. Dasso provide a 25 year Limited Warranty.



**Note:** All these are natural variations to natural materials; environmental conditions, such as air pollution, mold, mildew, etc., or staining from foreign substances such as dirt, grease, oil, etc.; Normal weathering from sunlight, weather and atmosphere, causing color change, checking, grain raise/ splintering, cupping and other forms of movement; variations and degradation in color/grain.



RESIDENTIAL AND COMMERCIAL APPLICATIONS





## Key Benefits

- No Nails & Screws in the surface (Secret Fixing system)
- Can leave to go grey or coat to keep looking smart.
- Fire Rating - Bal 29
- 90% harder than Merbau
- 70% less waste
- 30% faster to Install
- End Matched - to join between joists
- 50% less movement than Merbau
- No gaps to butt joints
- Stable when close to ground or near Moisture

## Other Products

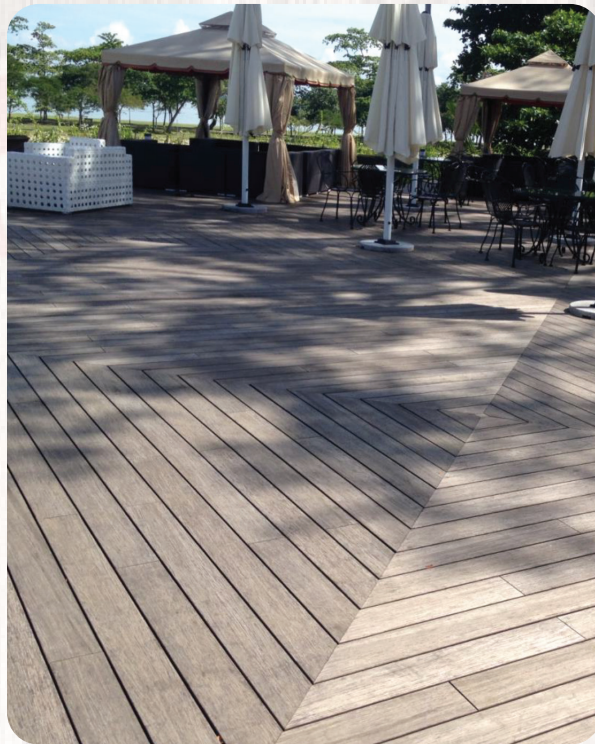

- Exterior wall cladding
- Soffit Lining
- Patio flooring (T&G) no gap decking

## All available in 2 colours

- XTR (Mahogany tone)
- Epic (Spotted Gum tone)



RESIDENTIAL AND COMMERCIAL  
APPLICATIONS

